

DIVI WORKSTATIONS®

DIVITYP018

AIS | IDEA STARTERS

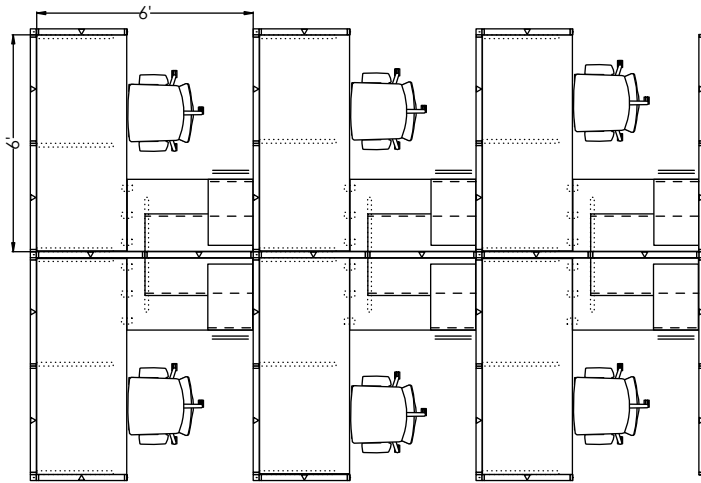

#	Part Number	Description	Quantity	Ext. List
1	4700	Upton - Black Mesh Back - Black Seat Fabric	6	\$4,986.00
2	E-DP6GFPB	Snap-In Data Plate w/6 Gang Face - Black	6	\$216.00
3	E-MW8W4DO1	Black Duplex Outlet - Line 1	3	\$243.00
4	E-MW8W4DO2	Black Duplex Outlet - Line 2	3	\$243.00
5	E-MW8W4DO3	Black Duplex Outlet - Line 3	3	\$243.00
6	E-MW8W4DO4	Black Duplex Outlet - Line 4 - Dedicated	3	\$243.00
7	E-MW8W4PJ36E	57 in. Electrical Jumper (Pt 36E & Vt 48)	2	\$712.00
8	E-MX8W4PTPC21	21 in. Electrical Jumper (Extended Panel To Panel)	1	\$231.00
9	E-UN8W4BFL	LH Receptacle Mounted Base Infeed - 72L - 8 Wire, 4 Circuit	1	\$550.00
10	P-DLBS3W	DIVI LINEAR BASE RACEWAY SHROUD 3-WAY 90 DEGREES	2	\$54.00
11	P-DLBS90	DIVI LINEAR BASE RACEWAY SHROUD 2-WAY 90 DEGREES	6	\$162.00
12	P-DLFRPM6636	DIVI LINEAR HARD PANEL-PWR-PERM MONO- 66H X 36W	4	\$5,452.00
13	P-DLFRPM6636	DIVI LINEAR Hard PANEL -NPWR-PERM MONO- 66H X 36W	10	\$10,000.00
14	P-DLQGWPRM6630	DIVI LINEAR QTR GLASS PANEL -NPWR- PERM MONO 66H X 30W	6	\$10,722.00
15	P-DLQGWPRM6636	DIVI LINEAR QTR GLASS PANEL -NPWR- PERM MONO 66H X 36W	8	\$15,656.00
16	P-DLSEOR	DIVI LINEAR BASE RACEWAY SHROUD END OF RUN	8	\$216.00
17	WPS-UNCT24L	Regular Cantilever - Left Hand - 24D	3	\$294.00
18	WPS-UNCT24R	Regular Cantilever - Right Hand - 24D	3	\$294.00
19	WPS-UNCT30L	Regular Cantilever - Left Hand - 30D	11	\$2,079.00
20	WPS-UNCT30R	Regular Cantilever - Right Hand - 30D	7	\$1,323.00
21	WPS-FP	Flat Plate	18	\$594.00
22	LEDTL-61024	24 Led Task Light, W/ Dimmer & Transformer	6	\$3,186.00
23	FDUDV36L	Type C Flipper Unit - Laminate Face - 36W	6	\$6,342.00
24	PEDFFJ24	Pedestal - F/F - 24D	6	\$6,690.00
25	WS2442	Rectangular - 2mm Edge - 24D x 42W	6	\$3,126.00
26	WS3072	Rectangular - 2mm Edge - 30D x 72W	6	\$6,186.00

Total List \$80,043.00

Pricing shown is for budgetary purposes only and subject to change. Pricelist Dates: 4/1/24. Contact your local Rep for a quote.
 Availability of finishes and materials shown may vary due to manufacturers' lifecycle management.
 More Idea Starters available at <https://www.ais-inc.com/resources/idea-starters>